

DRAFT
COPY

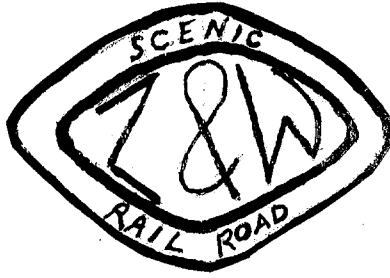

ZANESVILLE AND WESTERN SCENIC RAILROAD

EAST FULTONHAM, OHIO

SYSTEM TIMETABLE NUMBER

1

Effective 12:01 AM
June 1, 2010

For the Government of Employees Only

William Ratz
President

Charlie Thomas
Trainmaster

Thomas D. Barnett
MW Designate 49CFR 213.7

SAFETY IS ALWAYS FIRST PRIORITY

FORWARD

The Z & W Scenic Railroad is a 501(c)3 organization and by definition 49CFR, Part 209, does not provide common carriage freight and passenger transportation, and is not part of the general system of transportation within the U.S.

On January 9, 2008 the Z & W Scenic Railroad was formed to operate a part of the Ohio Rail Banked program line between FS and Glass Rock, Ohio, via East Fultonham, Ohio, in Muskingum and Perry counties of Ohio.

The mission of the Z & W Scenic Railroad is to provide a tourist destination and excursion train on an exceptionally scenic and historic rail line.

The near term goal of the Z & W Scenic Railroad is to activate the line, initially the first mile of East Fultonham depot as and under Excepted Track Rules as defined under 49CFR, Part 213 Track Safety Standards. Following activation under Excepted Track rules, the line will be rehabilitated by the Z & W Scenic Railroad and re-inspected for reclassification to a non-excepted FRA Class I Track Safety Standard. Upon approvals by appropriate regulatory and development entities, the Z & W Scenic Railroad's goal is to offer seasonal and special passenger excursion train service.

CONTACTS

ZANESVILLE AND WESTERN
SCENIC RAILROAD
PO BOX 32
East Fultonham, Oh 43735

Charlie Thomas	Trainmaster	740-281-7431	charlie thomas@zwsr.org
William Ratz	President	614-595-9701	wratz@columbus.rr.com
Art Ruck	Director MOW	614-496-8897	mow@ZWSR.org
Ed Gallis	Track Supvr.	740-408-3285	track supervisor@ZWSR.org
Tom Barnett	Designate 49CFR 213.7	330-323-0764 cell 330-738-2325 home	tombarnett01@verizon.net
Ron Jedlicka	Advisor to the Board	614-946-1234 cell 740-927-4985 home	pete@rpmrigging.com

SAFETY IS ALWAYS THE FIRST PRIORITY

STATION PAGE
Z&W SCENIC RAILROAD
ZANESVILLE LINE CLUSTER
COLUMBUS DIVISION

Z & W RUNNING TRACK

The direction from Glass Rock to East Fultonham is EASTWARD.
Mileposts between Glass Rock and MP 57.5, located east of East Fultonham, represents the distance from Columbus, Ohio.

STATION (code)	MILE POST	Notes
Begin Track	45.8	Sand Plant
Glass Rock (GR)	45.7	
Mt. Perry	50.0	
County Line	53.4	Boundry, Perry/Muskingum Counties.
O.H. Bridge	56.03	Route 22
Bridge 56.07	56.07	Jonathan Creek
West Wye Switch	56.10	Junction ex-PC Crooksville Runner.
West Yard Switch	56.15 (MP 5.00 FS)	East Fultonham Yard, north side.
East Fultonham (EF) *	56.20	Depot
East Wye Switch	56.25 (MP 4.88 FS)	Junction ex-NYC Shawnee Branch.
Tool House Switch	56.30 (MP 4.83 FS)	Stub Track, South side.
Dead Switch	56.86 (MP 4.65 FS)	Stub Switch, north side.
Cement Plant Crossing	56.90 (MP 4.62 FS)	Former private plant crossing.
Bridge 56.96	56.96 (MP 4.53 FS)	Buckeye Creek
Cement Marker	57.00 (MP 4.15 FS)	57 miles from Columbus via NYC.
Val Sta 1528+47	57.47 (MP 3.65 FS)	via Maysville Water District Property, Begin Plant Property.
Val Sta 163+03	3.09 (MP 3.09 FS)	End Plant Property

Z & W RUNNING TRACK
FULTONHAM SPUR

The direction from Val Sta 163+03 located MP 3.09 to FS Switch is Eastward.
Mileposts between Val Sta 163+03 located MP 3.09 to FS Switch represent the distance from FS Switch.

STATION (code)	MILE POST	Notes
Val Sta 163+03	3.09	End Plant Property
Slip	2.88	Slip 2.88 to 2.81
Route 93	0.50	State Highway Crossing, Flashers.
FS	0.00	Junction and Interchange with Ohio Central (Ohio Southern RR).

(* Denotes Open Office, as needed.

Via State Owned Rail Property

Via Maysville Water Dist. Owned Rail Property

Via State Owned

SPECIAL INSTRUCTIONS

BULLETIN BOARDS, EMPLOYEE REGISTER AND STANDARD CLOCK LOCATION:
East Fultonham, Oh. yard office.

METHOD OF OPERATION:

Yard Limits, all Z & W trackage is governed under Yard Limits. All movements in Yard Limits must be made at Yard Speed which is defined as a speed that permits stopping within one-half the range of vision, not to exceed 10 MPH.

ENGINE AND SPECIAL LOAD RESTRICTIONS:

Operation of six-axle locomotives is prohibited on Z & W Scenic Railroad trackage unless authorized by the President. Handling of cars in excess of 263,000 lbs. is prohibited on the Z & W Scenic Railroad trackage unless authorized by the President.

AUTOMATIC HIGHWAY CROSSING PROTECTION:

State Route 93 at-grade highway crossing MP 0.50 Fultonham Spur equipped with flashing lights. When train operations are infrequent, rusty rail conditions may develop at grade crossing signal locations. All train and engine movements must approach the crossing prepared to stop and manually flag protect the crossing if it can not be positively determined that automatic signal protection is functioning normally.

NORMAL POSITION OF SWITCHES:

All switches may be left lined as last used.

BOOK OF RULES IN EFFECT:

Z & W Scenic Railroad has adopted the Book of Rules of the ASL&RR Association.

HAZMAT RESTRICTION:

The handling of placarded HAZARDOUS material cars is not permitted without written authorization of the President.

INTERCHANGE:

FS MP 0.00 Fultonham Spur is designated interchange with the Ohio Central Railroad System (Ohio Southern Railroad). Interchange can be accommodated within the first mile Fultonham Spur.

EXCEPTED TRACK RULE:

Z&W Scenic Railroad designates all trackage excepted under 49CFR Part 213 Track Safety Rules. Z&W Scenic Railroad conducts operations on all trackage under the following conditions -

- (1) No train shall be operated at speeds in excess of 10 MPH.
- (2) No revenue passenger train shall be operated.
- (3) No freight train shall be operated that contains more than five cars required to be placarded by the Hazardous Materials Regulations (49CFR, Part 172).

*Change, eff 6/7/14 RR
Now CLASS 1
MP 50.10
to
MP 51.17*

BULLETIN ORDERS AND GENERAL ORDERS:

Bulletin orders will be consecutively issue under signature of Trainmaster and will be annulled, or consolidated into General Order format which will be tantamount to timetable special instruction.

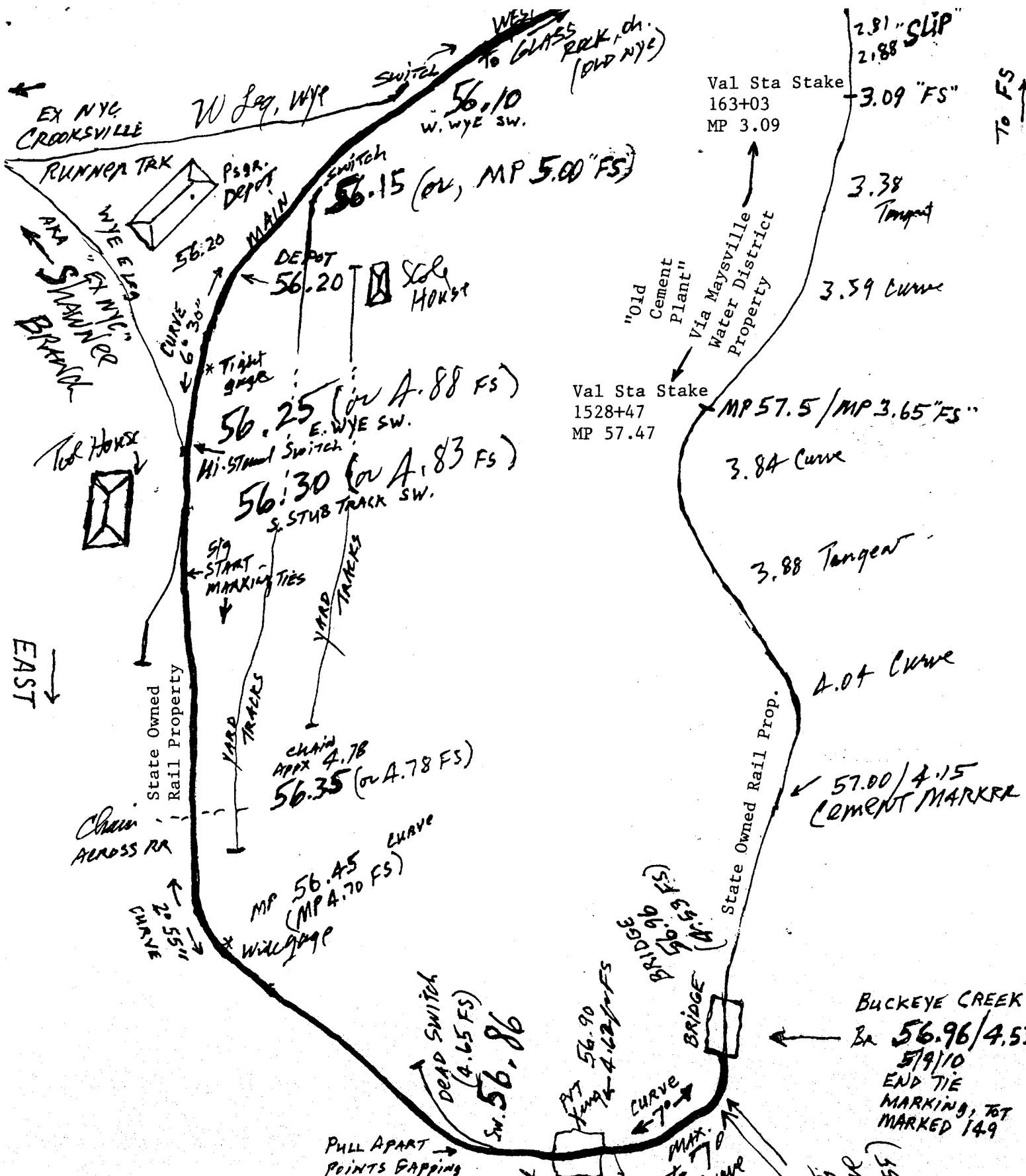

TRACK SCHEMATIC

Zanesville & Western Scenic Railroad
 East Fultonham, Ohio
 "First Mile East of Depot"
 NOT TO SCALE
 5-09-10 TDB

Xing. Cement
 56.90
 Xing
 4.62 FS
 MAX. TO 70' CURVE
 56.90
 4.62/FS
 BRIDGE
 CURVE 70'
 56.96/4.53
 BR
 5/9/10
 END TIE
 MARKING, TOT
 MARKED 149
 56.96/4.53
 2 pull
 2 points
 in curve
 (4.55)

MAP
 TIMETABLE #1 6/01/10
 Z&W SCENIC RAILROAD
 Appx. 15 Route Miles,
 Glass Rock, Oh.
 to
 FS Switch, Oh.
 via
 East Fultonham, Oh.
 Not to Scale - TDB
 5-14-10

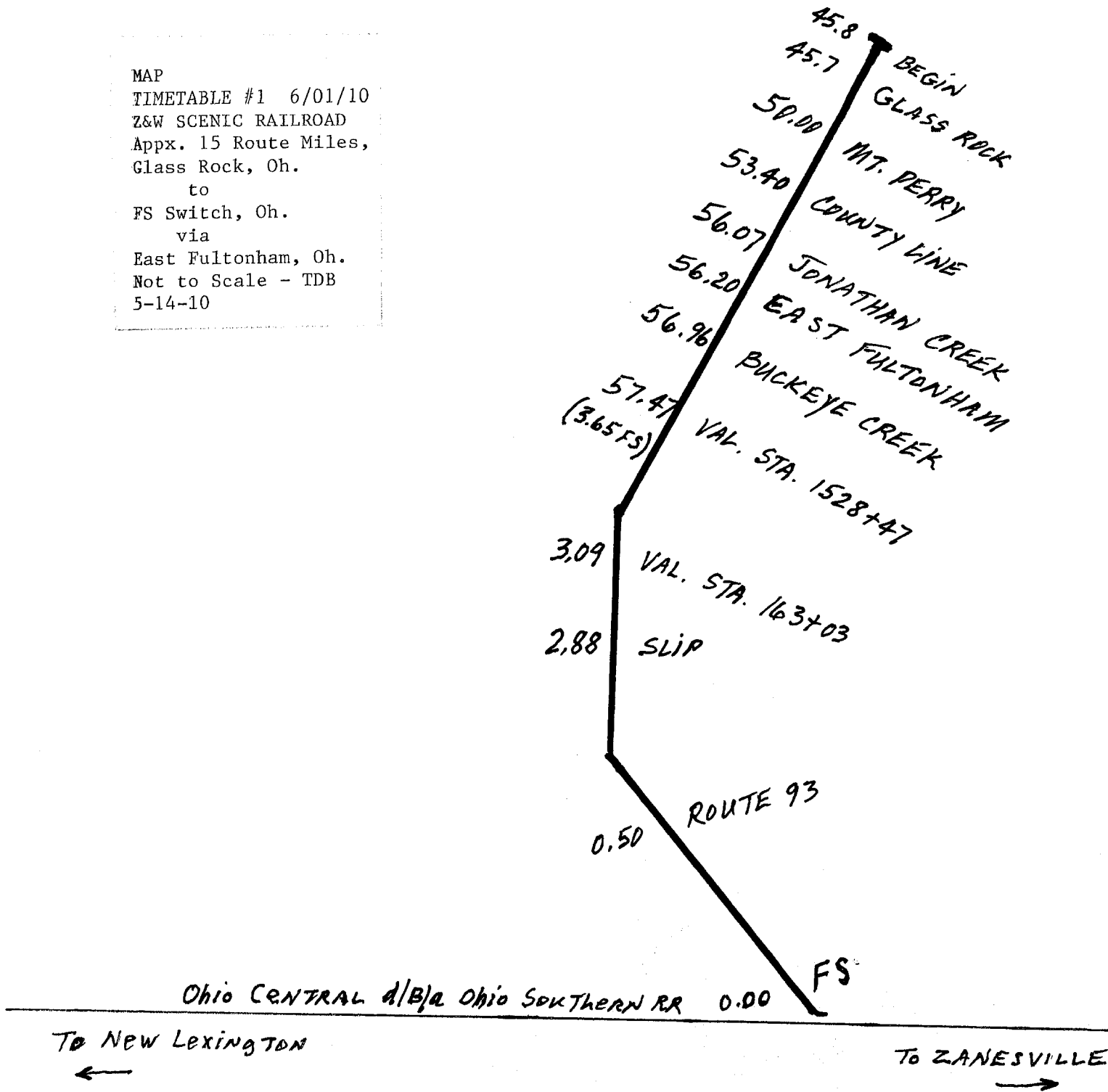

SAFETY IS ALWAYS THE FIRST PRIORITY