

**SASKATCHEWAN
SERVICE Area.
Wilkie sub**

**P & H
NEWLIFE**



**CANADIAN
PACIFIC
RAILWAY**

Westward

S23 428 FEET TO SPOT
S24 1 308 FEET PAST SPOT
S24 520 FEET TO SPOT
S24 2 162 FEET PAST SPOT
S25 670 FEET TO SPOT
S24 3 285 FEET PAST SPOT
STUB 271 FEET

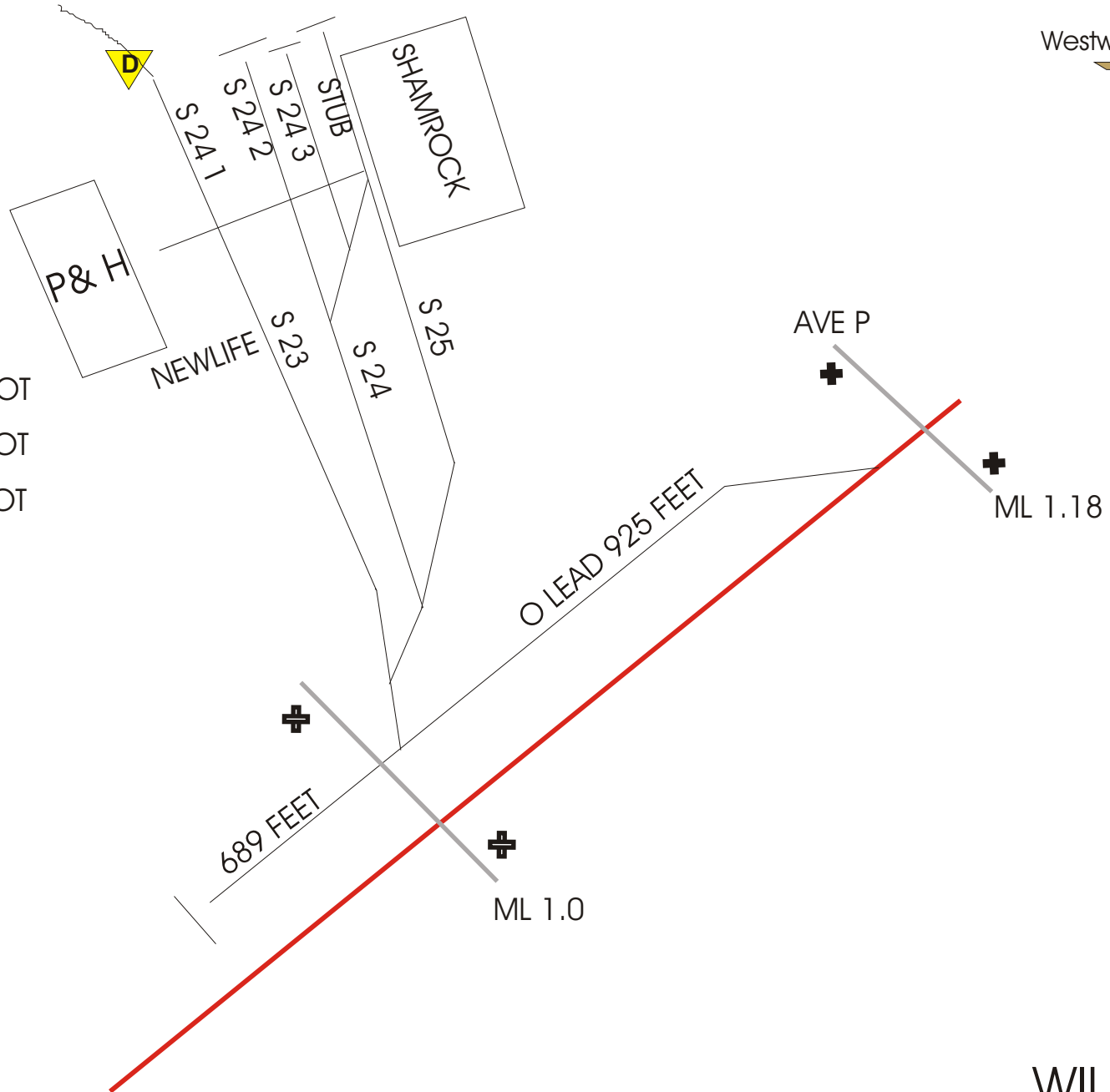

WIL 64

**SASKATCHEWAN
SERVICE AREA
Wilkie Sub.**

Ag Pro Grain Terminal



**CANADIAN
PACIFIC
RAILWAY**

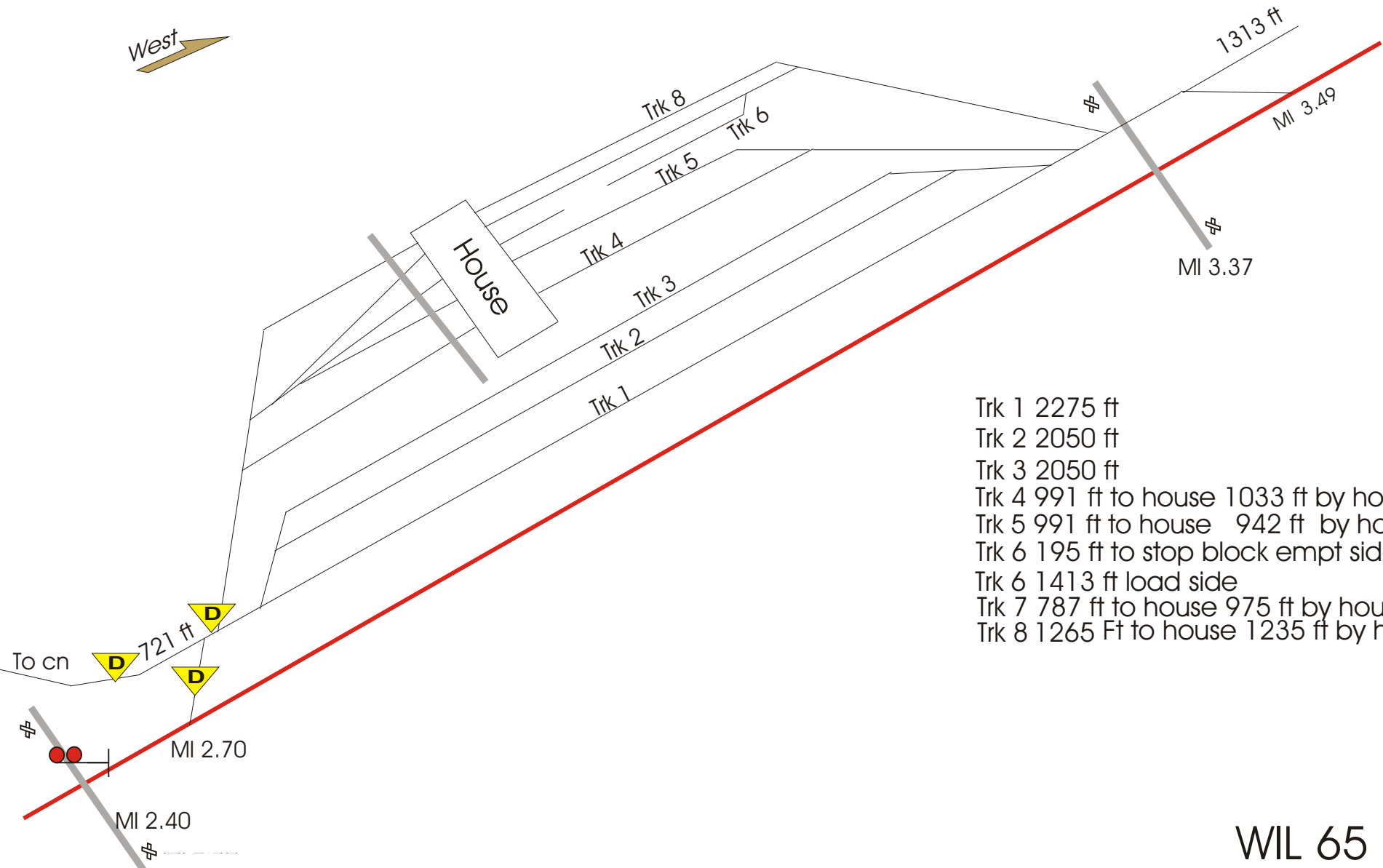

- Trk 1 2275 ft
- Trk 2 2050 ft
- Trk 3 2050 ft
- Trk 4 991 ft to house 1033 ft by house
- Trk 5 991 ft to house 942 ft by house
- Trk 6 195 ft to stop block empty side
- Trk 6 1413 ft load side
- Trk 7 787 ft to house 975 ft by house
- Trk 8 1265 Ft to house 1235 ft by house

WIL 65

**SASKATCHEWAN
SERVICE AREA
Wilkie Sub.**

Cory
6762



**CANADIAN
PACIFIC
RAILWAY**

Westward

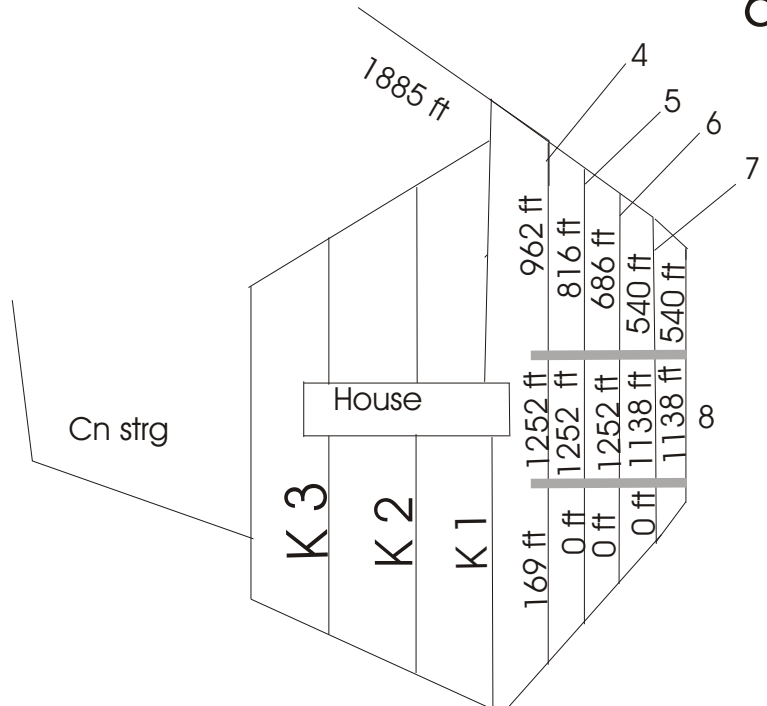

LL762

- K1 1027 ft to 1st cross & 802 to spot
- K2 793 ft to 1st cross & 802 to spot
- K3 575 ft to 1 cross & 802 to spot
- K 1 by hse 1752 ft
- K 2 by hse 1554 ft
- K 3 by hse 1394 ft

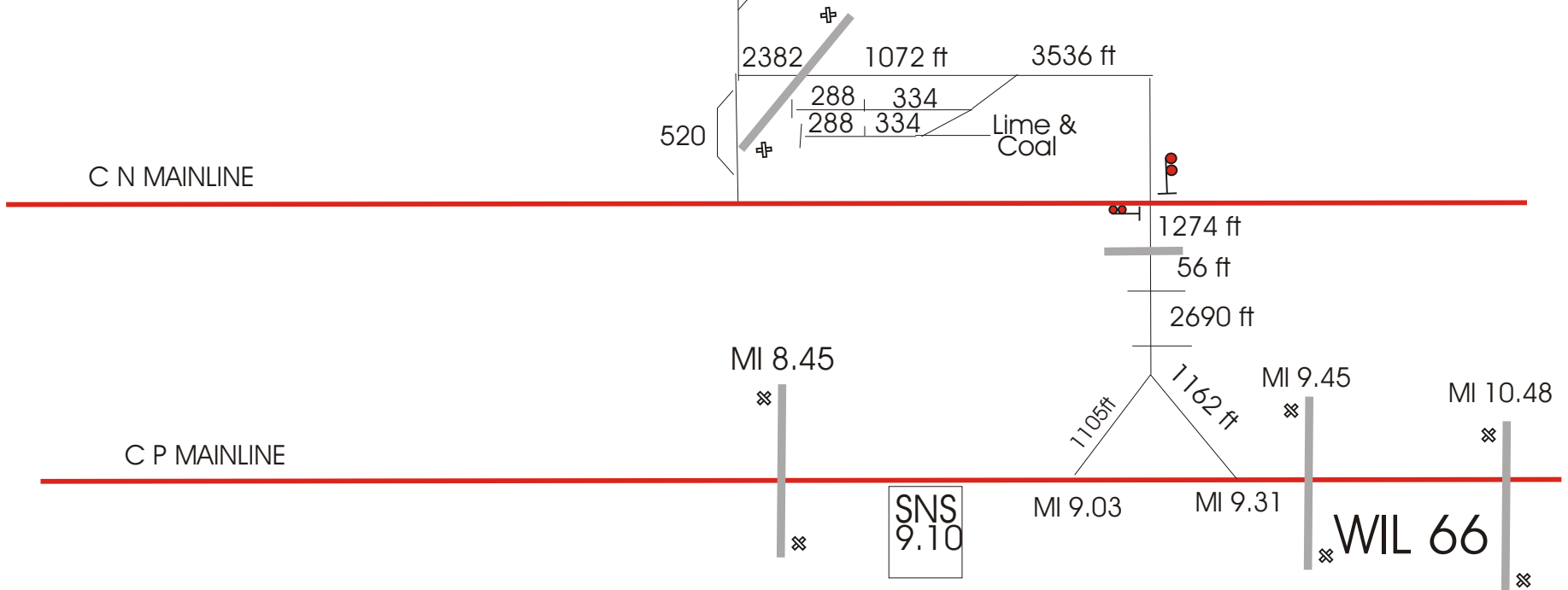

SASKATCHEWAN
SERVICE AREA
Wilkie Sub.

Dunfermline 6763



**CANADIAN
PACIFIC
RAILWAY**

Westward

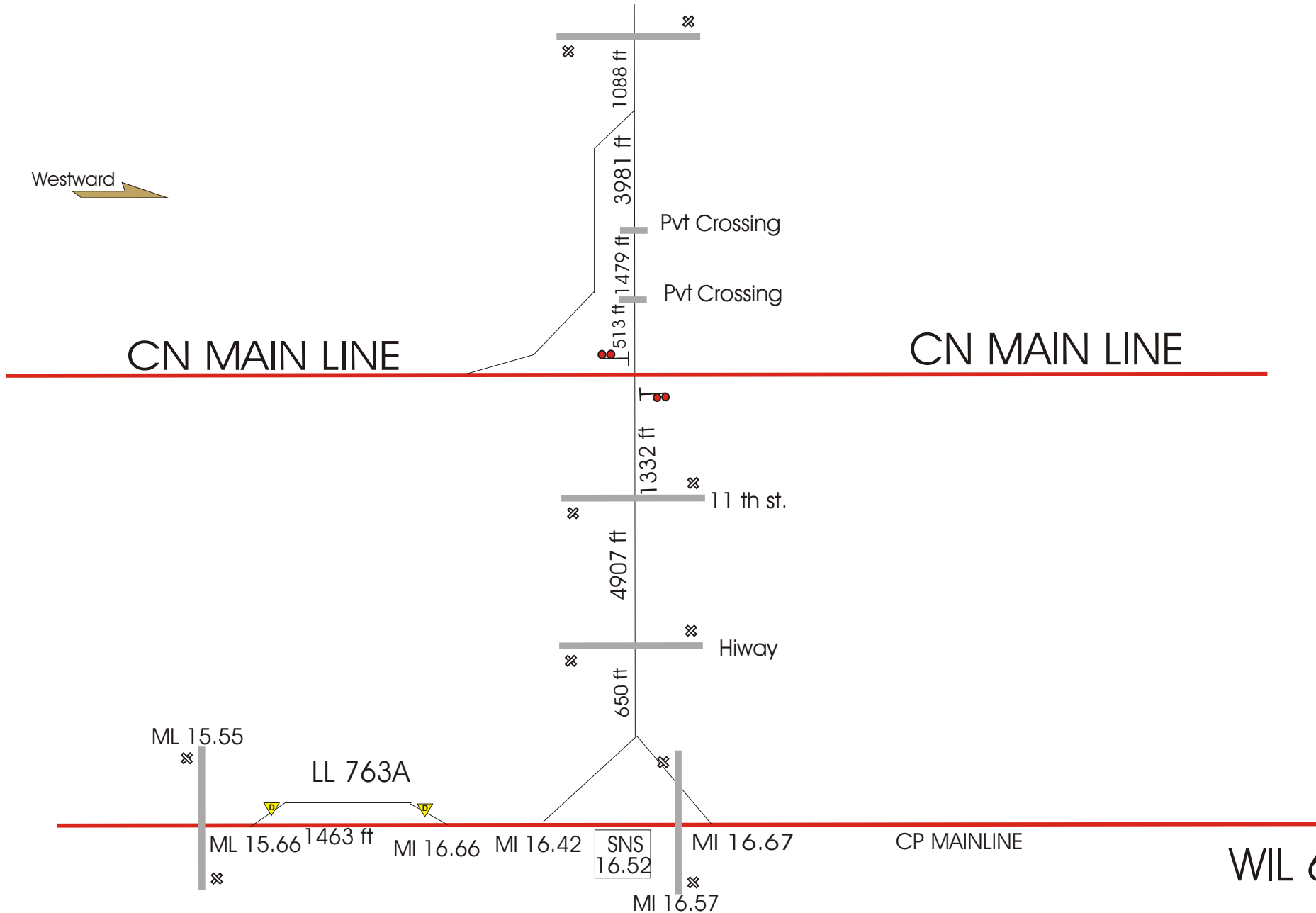

SASKATCHEWAN
SERVICE AREA
Wilkie Sub.

Agrium Mine
L761 & L761A



**CANADIAN
PACIFIC
RAILWAY**

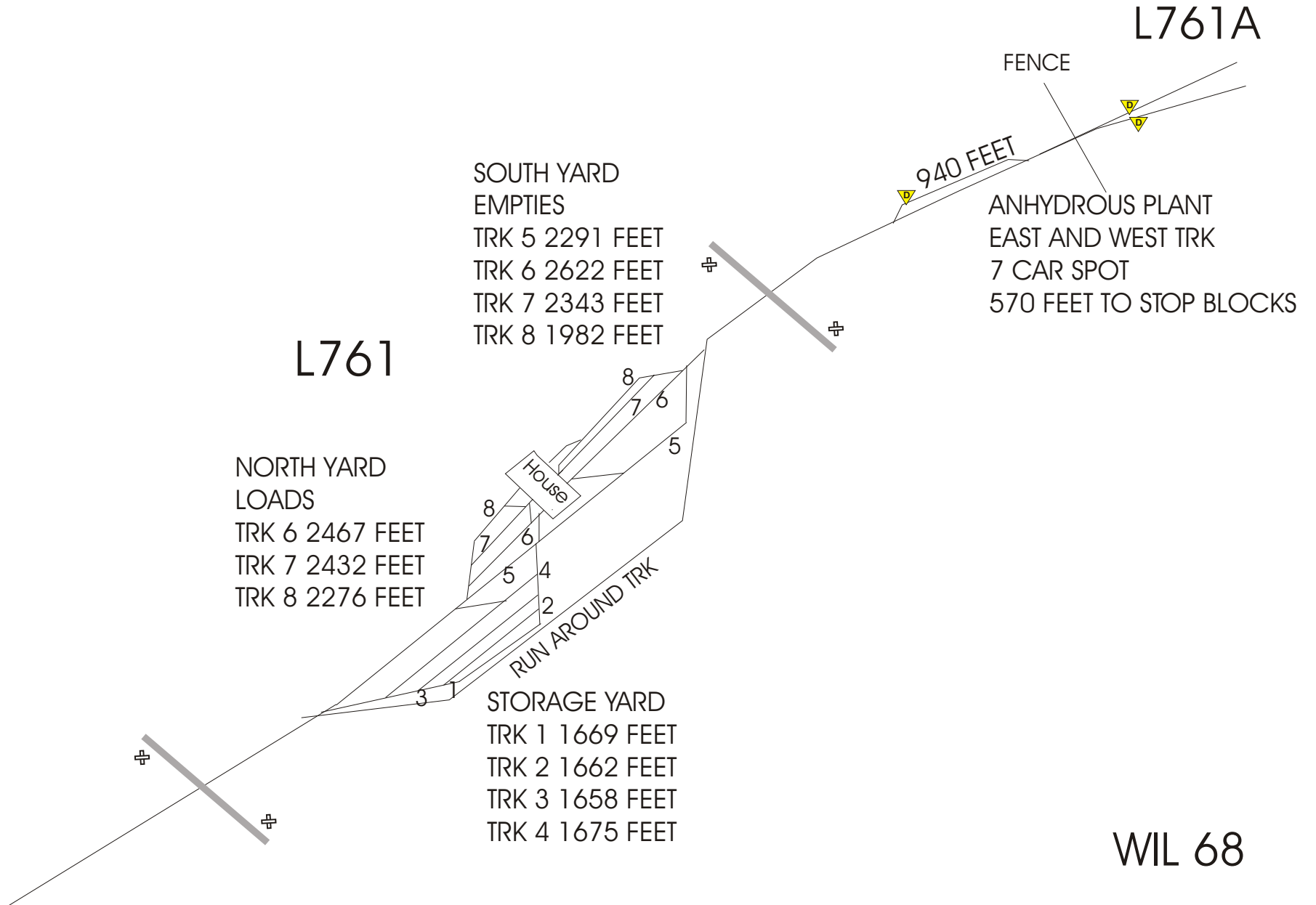

SASKATCHEWAN
SERVICE AREA
Wilkie Sub.

Asquith
6764



**CANADIAN
PACIFIC
RAILWAY**

West 

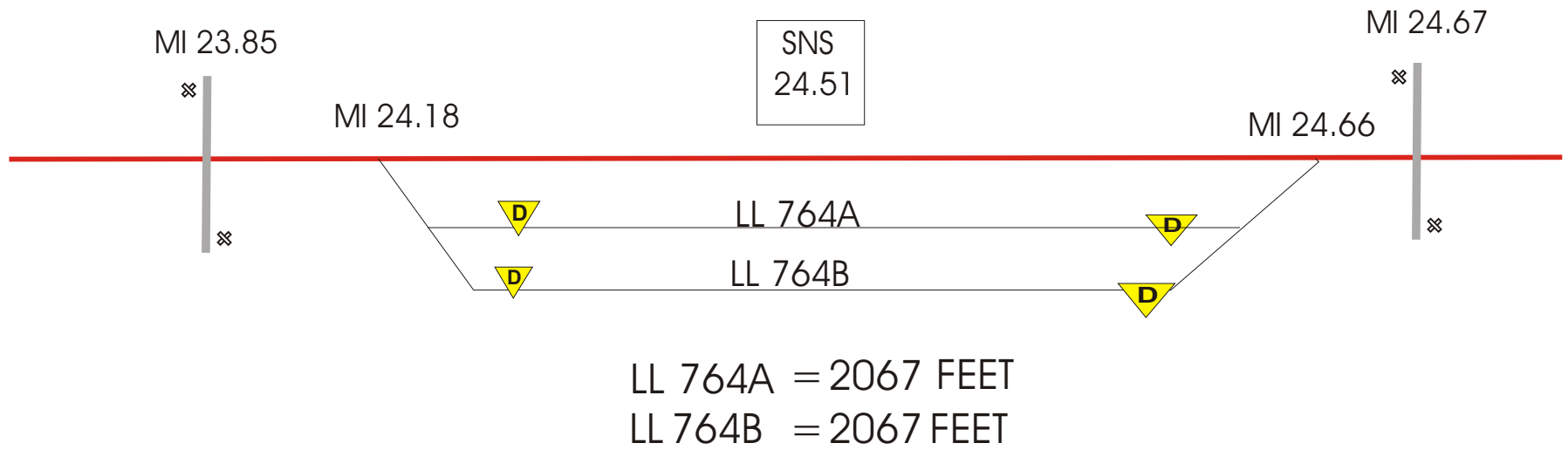

WIL 69

SASKATCHEWAN
SERVICE AREA
Wilkie Sub.

PERDUE 6768



**CANADIAN
PACIFIC
RAILWAY**

Westward 

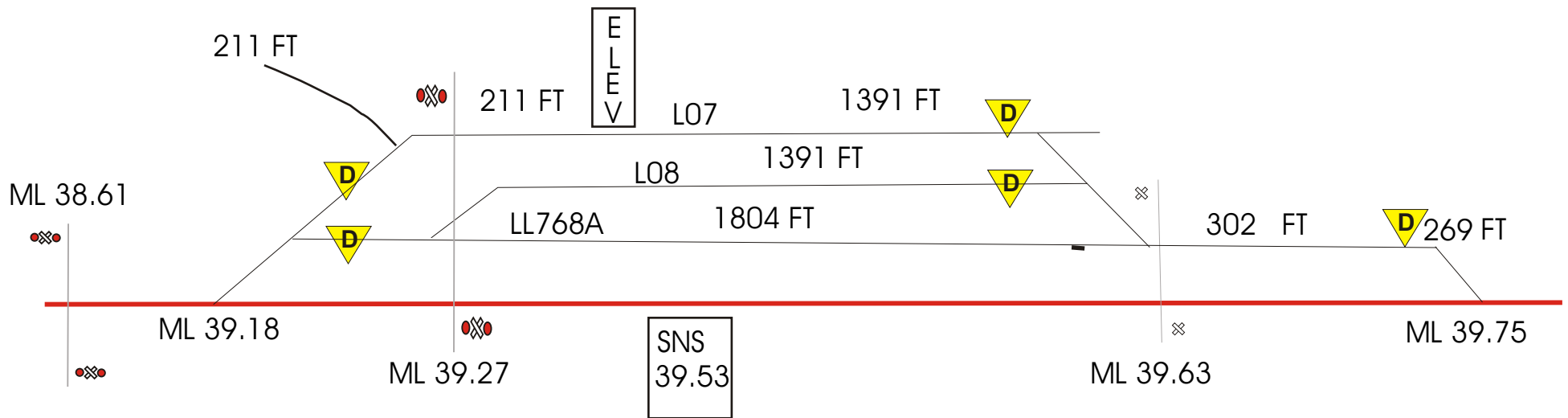

WIL 70

SASKATCHEWAN
SERVICE AREA
Wilkie Sub.

Biggar
6771



**CANADIAN
PACIFIC
RAILWAY**

West

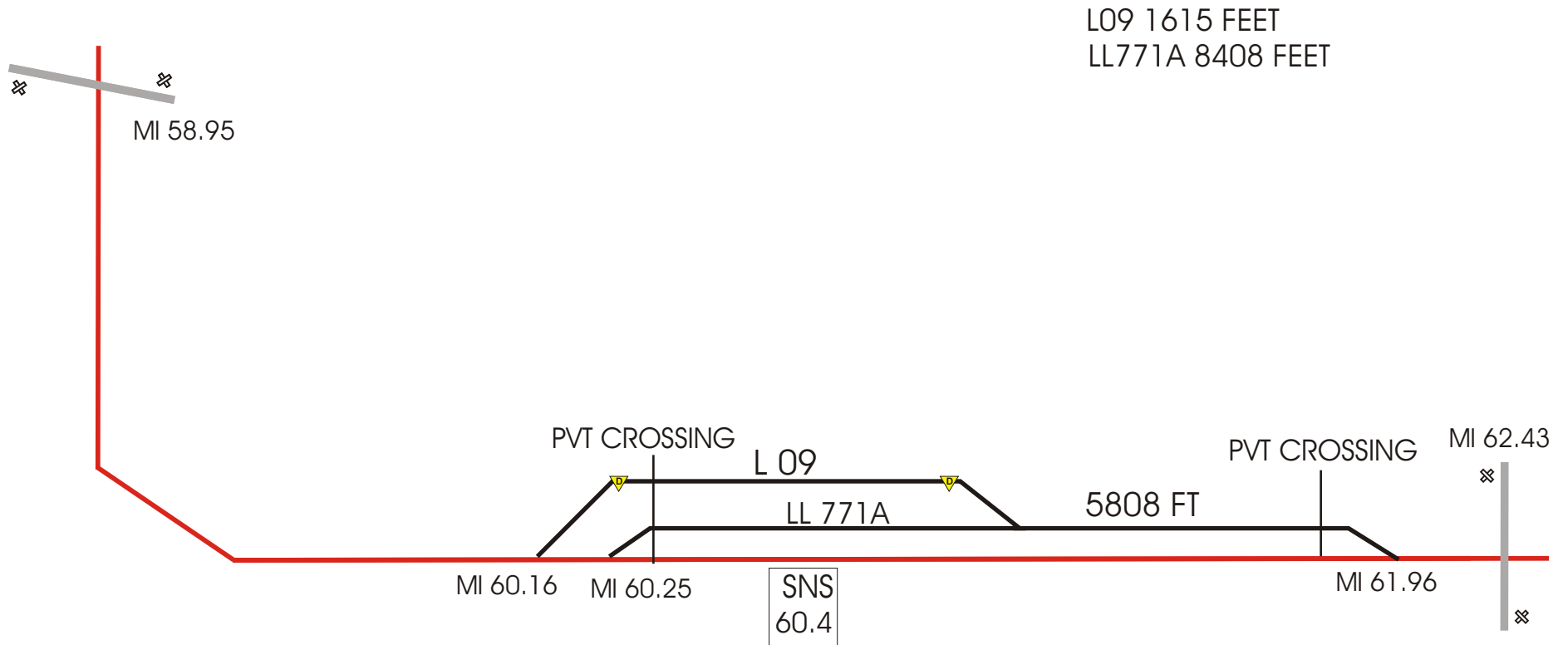

WIL 71

SASKATCHEWAN
SERVICE AREA
Wilkie Sub.

Trayner
6776



**CANADIAN
PACIFIC
RAILWAY**

West

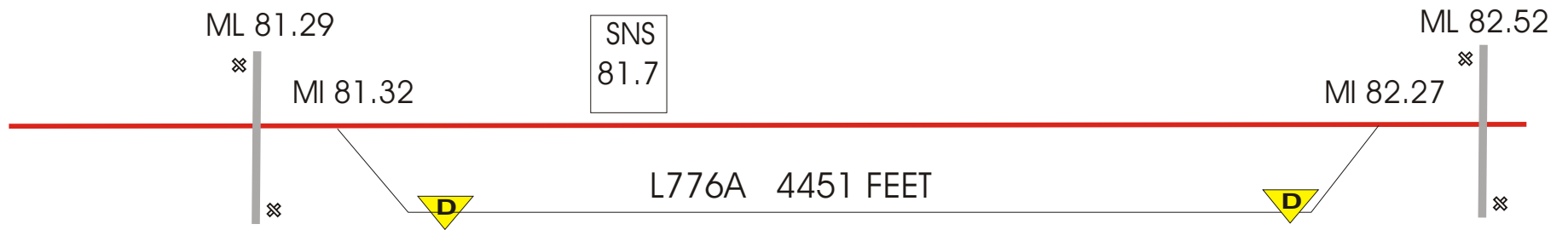

WIL 72

SASKATCHEWAN
SERVICE AREA
Wilkie Sub.

Wilkie Yard
 6780



**CANADIAN
 PACIFIC
 RAILWAY**

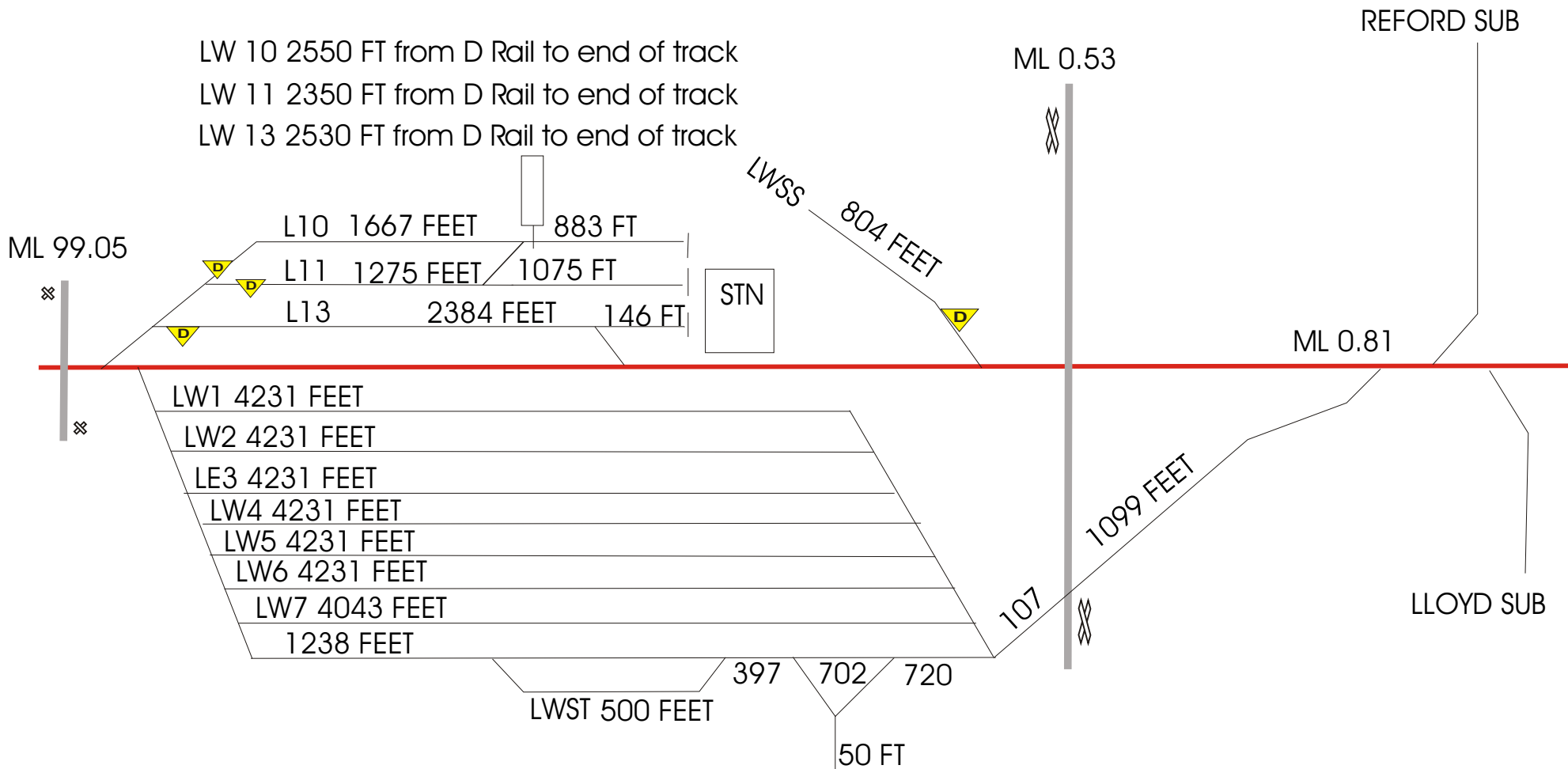

REFORD SUB

LLOYD SUB

WIL 73